

Part Number **HSR-067R** Contact Form A Switch Configuration SPST Rev. D

Maximum Sensitivity in a Miniature Size

Features	Advantages
<ul style="list-style-type: none"> Hermetically sealed contacts Switch materials are Lead free and RoHS compliant 	<ul style="list-style-type: none"> Not ESD sensitive Extended operations in extreme environments Excellent historical performance

Electrical Specifications

Power		Watts - maximum	4
Voltage	Switching	VDC - maximum	30
	Breakdown	VDC - minimum	350
Current	Switching	Amp - maximum	0.2
	Carry	Amp - maximum	1.3
Resistance	Initial Contact Resistance	Ohm - maximum	0.20
	Insulation Resistance	Ohm - minimum	1 E11
Capacitance	Contact	pF - typical	0.2
Temperature	Operating	°C	-40 to +125
	Storage	°C	-40 to +200

Magnetic Specifications

Pull - In Range		Ampere Turns	10-35
Test Coil		NARM RS-421-A	Coil I

Physical/Operational Specifications

Capsule Volume	Excluding Leads	CC - nominal	0.03
Contact Material			Rhodium
Operate Time	Including Bounce	mSeconds - maximum	0.40
Release Time	Including Bounce	mSeconds - maximum	0.10

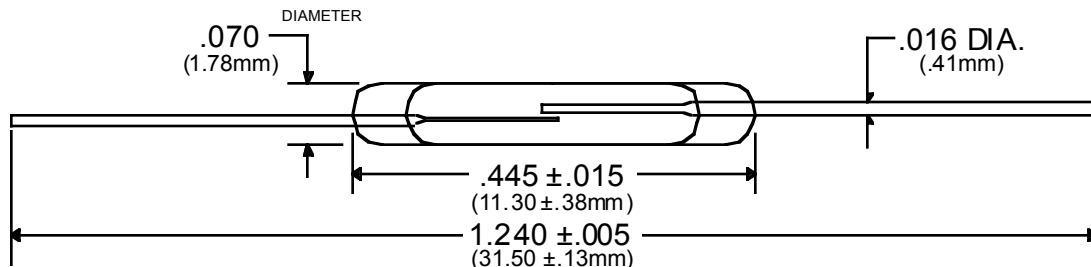

- Notes:
- Specifications are not constant across entire magnetic range.
 - Customer must exercise care in handling, mounting, lead forming, and cutting to prevent damage to glass capsule and/or switch sensitivity.
 - For information or custom configurations about performance, mounting options or packaging, contact our Sales department.
 - Information contained hereon is for informational purposes only and should not be deemed as accurate for a specific application. Consult factory for specific application information and/or latest revision.