

Part Number **HSR-196W** Contact Form A Switch Configuration SPST Rev. D

100 Watt Power Rated Switch

Features	Advantages
<ul style="list-style-type: none"> Hermetically sealed contacts Solid Tungsten contacts Flattened external leads suitable for welding, soldering, etc. Leaded glass currently exempted from RoHS requirements 	<ul style="list-style-type: none"> Extended operations in extreme environments Not ESD sensitive Suitable for high/inductive current loads Capable of switching power loads between 3 and 100 watts

Electrical Specifications

Power		Watts - maximum	100
Voltage	Switching	VDC - maximum	120
	Breakdown	VDC - minimum	600
Current	Switching	Amp - maximum	3
	Carry	Amp - maximum	4
Resistance	Initial Contact Resistance	Ohm - maximum	0.50
	Insulation Resistance	Ohm - minimum	1 E9
Capacitance	Contact	pF - typical	1.4
Temperature	Operating	°C	-40 to +125
	Storage	°C	-40 to +200

Magnetic Specifications

Pull - In Range		Ampere Turns	50-100
Test Coil		NARM RS-421-A	Coil IV

Physical/Operational Specifications

Capsule Volume	Excluding Leads	CC - nominal	1.13
Contact Material			Tungsten Bar and Plate
Operate Time	Including Bounce	mSeconds - maximum	3.20
Release Time	Including Bounce	mSeconds - maximum	1.20

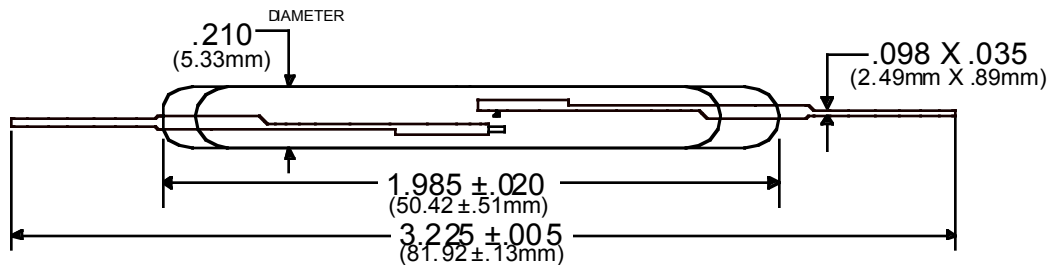

- Notes:
- Specifications are not constant across entire magnetic range.
 - Customer must exercise care in handling, mounting, lead forming, and cutting to prevent damage to glass capsule and/or switch sensitivity.
 - For information or custom configurations about performance, mounting options or packaging, contact our Sales department.
 - Information contained hereon is for informational purposes only and should not be deemed as accurate for a specific application. Consult factory for specific application information and/or latest revision.