

Part Number **HSR-170R** Contact Form A Switch Configuration SPST Rev. D

Ideally Sized Switch for a Range of Applications

Features	Advantages
<ul style="list-style-type: none"> • Hermetically sealed contacts • Universal design • Flattened external leads suitable for welding, soldering, etc. • UL recognized component 	<ul style="list-style-type: none"> • Extended operations in extreme environments • Not ESD sensitive • Ideal for large form A relays

Electrical Specifications

Power		Watts - maximum	25
Voltage	Switching	VDC - maximum	200
	Breakdown	VDC - minimum	500
Current	Switching	Amp - maximum	1
	Carry	Amp - maximum	8
Resistance	Initial Contact Resistance	Ohm - maximum	0.10
	Insulation Resistance	Ohm - minimum	1 E9
Capacitance	Contact	pF - typical	0.8
Temperature	Operating	°C	-40 to +125
	Storage	°C	-40 to +200

Magnetic Specifications

Pull - In Range		Ampere Turns	40-80
Test Coil		NARM RS-421-A	Coil III

Physical/Operational Specifications

Capsule Volume	Excluding Leads	CC - nominal	0.74
Contact Material			Rhodium
Operate Time	Including Bounce	mSeconds - maximum	2.50
Release Time	Including Bounce	mSeconds - maximum	1.80

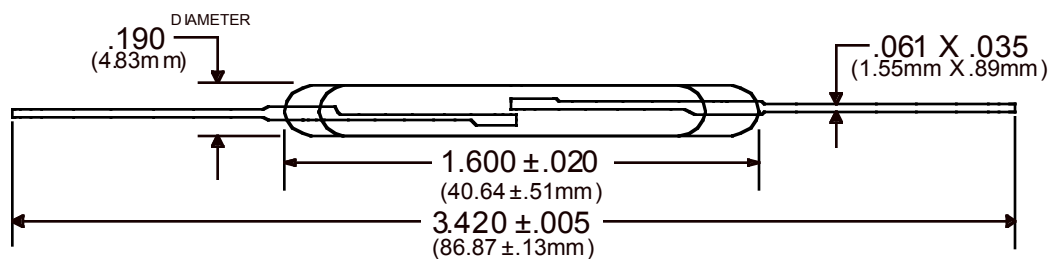

- Notes:
- (1) Specifications are not constant across entire magnetic range.
 - (2) Customer must exercise care in handling, mounting, lead forming, and cutting to prevent damage to glass capsule and/or switch sensitivity.
 - (3) For information or custom configurations about performance, mounting options or packaging, contact our Sales department.
 - (4) Information contained hereon is for informational purposes only and should not be deemed as accurate for a specific application. Consult factory for specific application information and/or latest revision.

Part Number **HSR-170R** Contact Form A Switch Configuration SPST Rev. D

Ideally Sized Switch for a Range of Applications

Features	Advantages
<ul style="list-style-type: none"> Leaded glass currently exempted from RoHS requirements 	

Electrical Specifications

Power		Watts - maximum	25
Voltage	Switching	VDC - maximum	200
	Breakdown	VDC - minimum	500
Current	Switching	Amp - maximum	1
	Carry	Amp - maximum	8
Resistance	Initial Contact Resistance	Ohm - maximum	0.10
	Insulation Resistance	Ohm - minimum	1 E9
Capacitance	Contact	pF - typical	0.8
Temperature	Operating	°C	-40 to +125
	Storage	°C	-40 to +200

Magnetic Specifications

Pull - In Range		Ampere Turns	40-80
Test Coil		NARM RS-421-A	Coil III

Physical/Operational Specifications

Capsule Volume	Excluding Leads	CC - nominal	0.74
Contact Material			Rhodium
Operate Time	Including Bounce	mSeconds - maximum	2.50
Release Time	Including Bounce	mSeconds - maximum	1.80

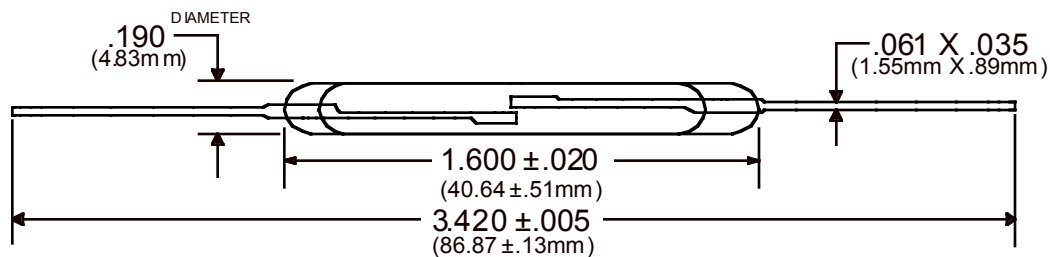

Notes:

- Specifications are not constant across entire magnetic range.
- Customer must exercise care in handling, mounting, lead forming, and cutting to prevent damage to glass capsule and/or switch sensitivity.
- For information or custom configurations about performance, mounting options or packaging, contact our Sales department.
- Information contained hereon is for informational purposes only and should not be deemed as accurate for a specific application. Consult factory for specific application information and/or latest revision.