

Part Number **HSR-510R** Contact Form C Switch Configuration SPDT Rev. F

**Industry Standard SPDT Reed Switch**

Features	Advantages
<ul style="list-style-type: none"> <li>Hermetically sealed contacts</li> <li>Leaded glass currently exempted from RoHS requirements</li> </ul>	<ul style="list-style-type: none"> <li>Extended operations in extreme environments</li> <li>Not ESD sensitive</li> <li>Ideal for proximity sensors and reed relays</li> </ul>

**Electrical Specifications**

Power		Watts - maximum	3
Voltage	Switching	VDC - maximum	120
	Breakdown	VDC - minimum	400
Current	Switching	Amp - maximum	0.25
	Carry	Amp - maximum	TBD
Resistance	Initial Contact Resistance	Ohm - maximum	0.15
	Insulation Resistance	Ohm - minimum	1 E9
Capacitance	Contact	pF - typical	2.1
Temperature	Operating	°C	-40 to +125
	Storage	°C	-40 to +200

**Magnetic Specifications**

Pull - In Range		Ampere Turns	15-45
Test Coil		NARM RS-421-A	Coil II

**Physical/Operational Specifications**

Capsule Volume	Excluding Leads	CC - nominal	0.08
Contact Material			Rhodium
Operate Time	Including Bounce	mSeconds - maximum	1.30
Release Time	Including Bounce	mSeconds - maximum	0.60

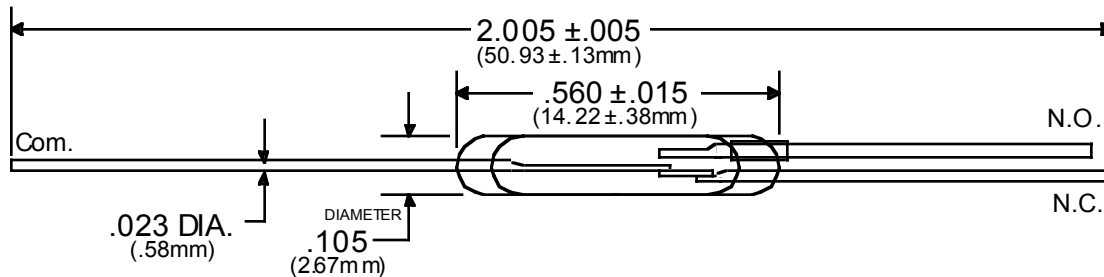

- Notes:
- Specifications are not constant across entire magnetic range.
  - Customer must exercise care in handling, mounting, lead forming, and cutting to prevent damage to glass capsule and/or switch sensitivity.
  - For information or custom configurations about performance, mounting options or packaging, contact our Sales department.
  - Information contained hereon is for informational purposes only and should not be deemed as accurate for a specific application. Consult factory for specific application information and/or latest revision.